

ecolight

LED

CRI 90

IP 20

0.5m



160mm I



82mm



51mm

LED | 6W | 3000K | 420Lm | Non Dimmable

Included LED Driver 160mA

Material: Aluminium



60mm



90mm

Please read instructions before commencing installation and retain for future reference.

INSTALLATION INSTRUCTIONS

 Electrical products can cause death, injury, or damage to property. Maintenance and installation should only be carried out by a professional electrician.

- Ensure main supply is switched off.
- Cut Out Hole Ø51mm and Depth 90mm required into the mounting surface.
- Connect main spot with the appropriate driver, making sure all connections are tight (LED driver 160mA included).
- Move the springs to an upright position.
- Insert the spot inside of the hole and return the springs to a vertical position.
- Reconnect power.

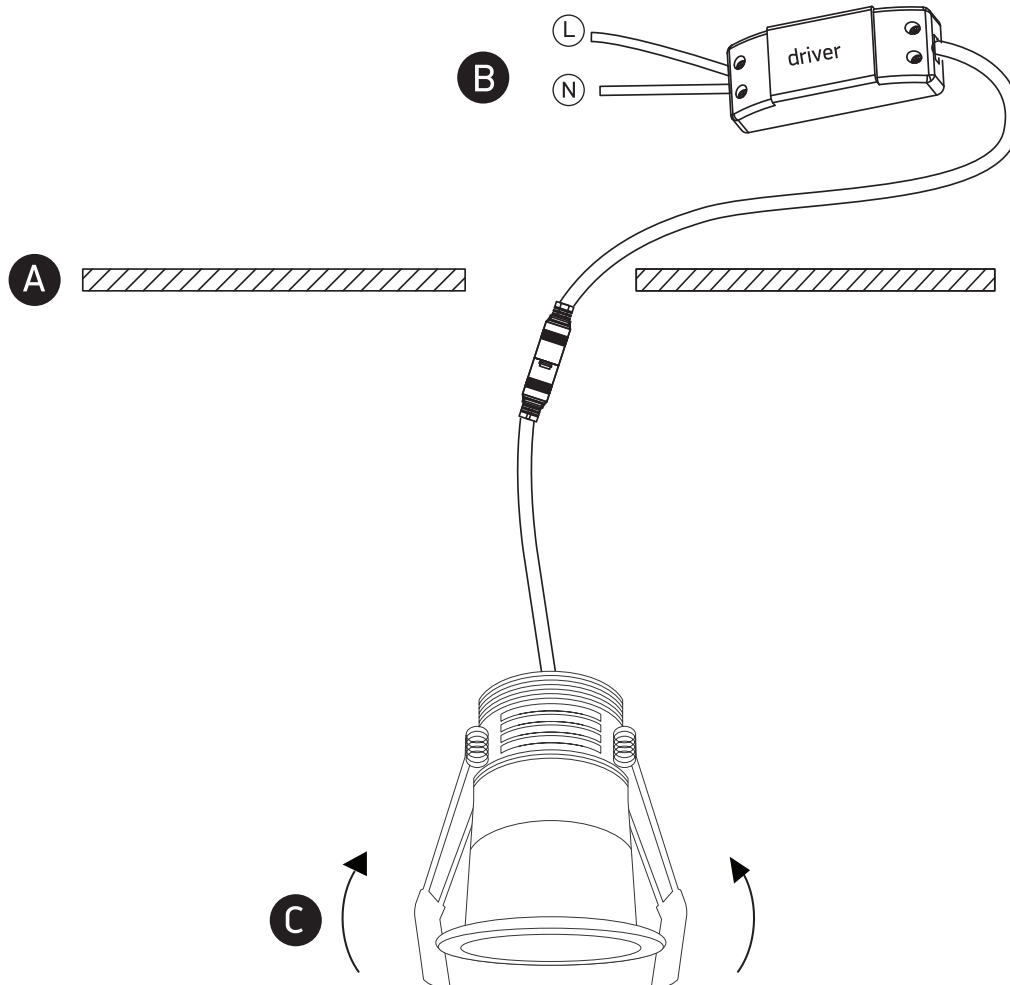

WARNING

- Make sure that the products is installed properly before connecting to electricity.
- Do not cover the fitting.
- Not for outdoor use or in wet conditions.
- Do not exceed the maximum wattage rating of the lamp.

