

Connecting the Terminal Block

Connect main supply (brown - Live, blue - Neutral) into terminal block making sure all connections are tight.

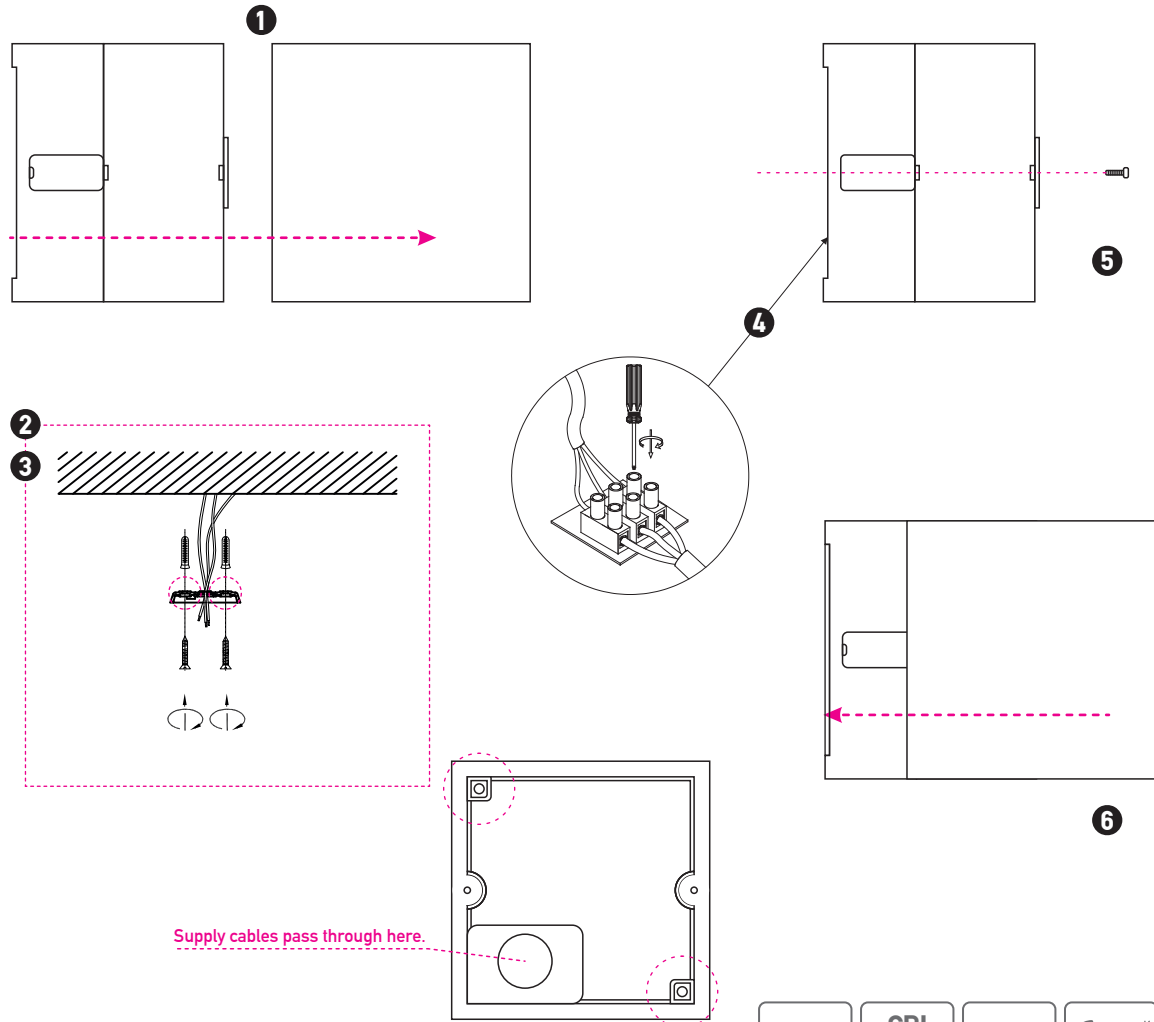

OUTDOOR WALL LIGHT

E109

Please read instructions before commencing installation and retain for future reference.

SPECIFICATIONS

- **Material:** Aluminum + Tempered Glass
- **Lamp Type:** LED , 2x 3W , 3000K , 480Lm , CRI 80
- **Ingress Protection:** IP54. Protection against entry of solid objects greater than 12mm in diameter.

INSTALLATION INSTRUCTIONS

- ⚠ **Electrical products can cause death, injury, or damage to property. Maintenance and installation should only be carried out by a professional electrician.**
- ⚠ **The light source contained in this luminaire shall only be replaced by the manufacturer or his service agent or a similar qualified person.**

- Ensure main supply is switched off.
- Remove the outer surface of the fixture from the main body (1).
- Insert wall anchors into mounting surface (2).
- Fit mounting bracket onto mounting surface with self-tapping screws (3).
- Connect main supply wires to terminal block (4) making sure all connections are tight.
- Fit wall fixture onto mounting bracket with smallest screws (5).
- Reattach the outer surface of the fixture to the main body (6).
- Reconnect power.

WARNING

- Make sure that the products is installed properly before connecting to electricity.
- Do not cover the fitting.

